

WicoLine Push WLS

Push fittings for absorbing horizontal compression forces

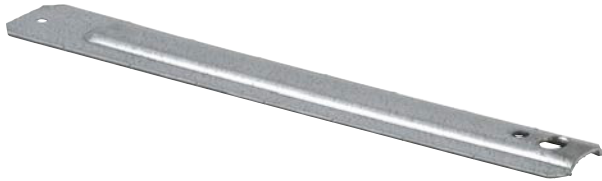
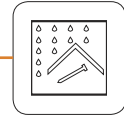

Dimensions: Length: 170-370 mm
Materials: S250GD + Z275MA
 According to: EN10346
Surface treatment: Hot galvanised approx. 20 µm
Application class: 1-2

Scale drawing

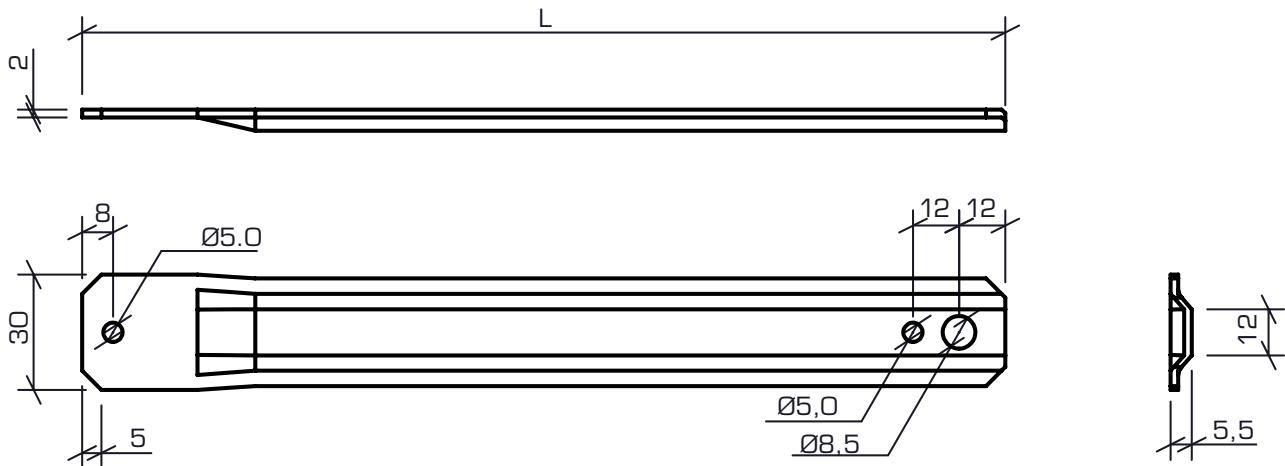

Type	Dimension L x W x t [mm]	Number of holes Ø5 [mm]	Number of holes Ø8.5 [mm]	Weight [g]	Number of units in cardboard box	Number of cardboard boxes per pallet	DB no.	ITW no.
WLS 170	170 x 30 x 2 x 5	2	1	80	50	80	1869753	210980
WLS 190	190 x 30 x 2 x 5	2	1	89	50	80	1869754	210981
WLS 200	200 x 30 x 2 x 5	2	1	94	50	80	1869755	210982
WLS 215	215 x 30 x 2 x 5	2	1	101	50	80	1869756	210983
WLS 225	225 x 30 x 2 x 5	2	1	106	50	80	1869757	210984
WLS 240	240 x 30 x 2 x 5	2	1	113	50	80	1869758	210985
WLS 250	250 x 30 x 2 x 5	2	1	118	50	80	1869759	210986
WLS 290	290 x 30 x 2 x 5	2	1	136	50	80	1869760	210987
WLS 350	350 x 30 x 2 x 5	2	1	165	50	80	1869761	210988
WLS 370	370 x 30 x 2 x 5	2	1	174	50	80	1869762	210989

ITW Construction Products OÜ
 Türi 10D • 11314 Tallinn • Estonia
 T +372 651 2462 • F +372 651 2463
www.itwconstruction.ee